



Specification Sheet

Sundolitt Expanded Polystyrene Blocks for embankment building, landscaping & void-fill



Reference	Density*	Compressive Stress@1% Strain*	Design Load*	Block Dimensions* Length x Width x Thickness	Block Volume*
	kg/m ³	kPa	kg/m ³	mm	m ³
SD (S70)	15	20	7,000	2400x1200x1000	2.88
HD (100)	18	40	10,000	2400x1200x1000	2.88
EHD (S150)	23.5	70	15,000	2400x1200x1000	2.88
UHD (S200)	30	90	20,000	2400x1200x1000	2.88
S250	35	100	25,000	2400x1200x1000	2.88
S300	38	120	30,000	2400x1200x1000	2.88
S350	43	140	35,000	2400x1200x1000	2.88

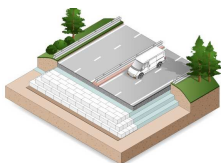

Road Construction

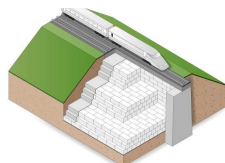

Embankments

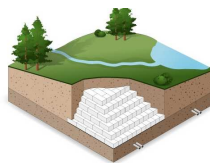

Landscaping

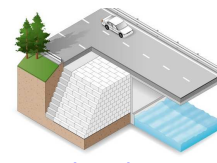

Bridge Abutments

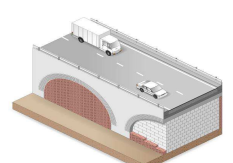

Bridge Underfills

- Blocks for civils applications manufactured in compliance with **BSEN 14933** (which came into effect on 1st January 2009)
An EPS product manufactured in compliance with BSEN 14933, if subjected to a permanent compressive stress of 30% of its nominal Design Load, should deform by 2% or less after 50 years
- Euroclass type **f** material supplied as standard

Customised Products

- Other block dimensions & densities available on request
- Euroclass type **e** – self-extinguishing material available to order

Available in
SHEET FORM
for insulation in
construction projects

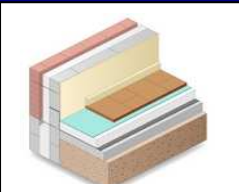

Above Concrete Slab

Sundolitt Ltd

Gateshead Factory
Bath Road
Green Lane Industrial Estate
Gateshead, Tyne & Wear
NE10 0JT
Tel: 0191 438 1023
Fax: 0191 495 4111

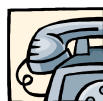

EPS Block Order Hotline
0845 602 2309

Stirling Head Office
Suite A2, Stirling Agricultural Centre, Stirling FK9 4RN
Tel: 01786 471586 Fax: 01786 464825
www.sundolitt.co.uk

29th July 2016