

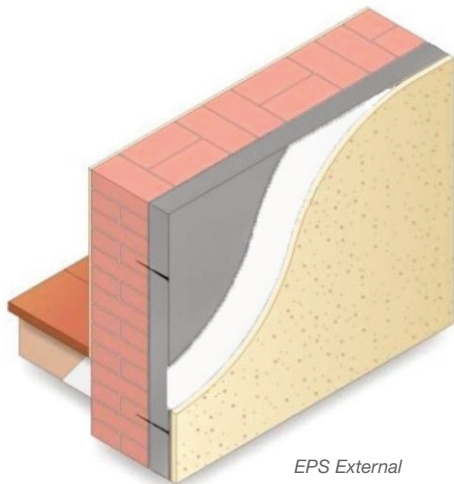

EPS

CLIMATE® EXTERNAL WALL INSULATION

Product Briefing and Data Sheet



EPS External
Wall Board

Sundolitt Climate EWI is low lambda expanded polystyrene insulation designed specifically for external wall insulation.

EPS insulation has been awarded the highest possible rating A+ by BRE Green Guide to Specification.

- All products are manufactured in compliance with BS EN 13163
- All products accredited to BS EN ISO 9001 and ISO 14001 certification
- Standard material is Euroclass e (flame retardant).

Sundolitt Gateshead

Bath Road, Green Lane, Gateshead, Tyne & Wear NE10 0JT
Tel: +44 (0)191 438 1023 Fax: +44 (0) 191 495 4111

Email: sales.gateshead@sundolitt.com

www.sundolitt.co.uk

Sundolitt Head Office

Suite A2, Stirling Agricultural Centre, Stirling FK9 4RN
Tel: +44 (0)1786 471 586 Fax +44 (0)1786 464 825

Email: enquiriesuk@sundolitt.com



Serving the Construction Industry



EPS

CLIMATE® EXTERNAL WALL INSULATION

Product Data

Grade	Density*	Thermal Conductivity	Compressive Stress @ 10% Deformation	Sheet Dimensions* Length x Width x Thickness
	kg/m ³	W/m ² K	kPa	mm
CE70	15	0.031	70	1200 x 600 x 50mm – 250mm
CE100	20	0.031	100	1200 x 600 x 50mm – 250mm

* All values are nominal

Declared designation codes/level or class — BS EN 13163 : 2001	
Characteristic	Level/classes
Length	L1
Width	W1
Thickness	T1
Squareness	S1
Flatness	P1
Compressive stress (min) at 10% deformation(1)	CS(10)70, CS(10)100, CS(10)150, CS(10)200
Dimensional stability at 23°C/50% RH(1)	DS(N)5
Water absorption by immersion(1) total (%)	WL(T)5

(1) For 50 mm thicknesses only.



Sundolitt Gateshead

Bath Road, Green Lane, Gateshead, Tyne & Wear NE10 0JT
Tel: +44 (0)191 438 1023 Fax: +44 (0) 191 495 4111

Email: sales.gateshead@sundolitt.com

www.sundolitt.co.uk

Sundolitt Head Office

Suite A2, Stirling Agricultural Centre, Stirling FK9 4RN
Tel: +44 (0)1786 471 586 Fax +44 (0)1786 464 825

Email: enquiriesuk@sundolitt.com



Serving the Construction Industry